

8 7 6 5 4 3 2 1

D

D

C

C





B

B

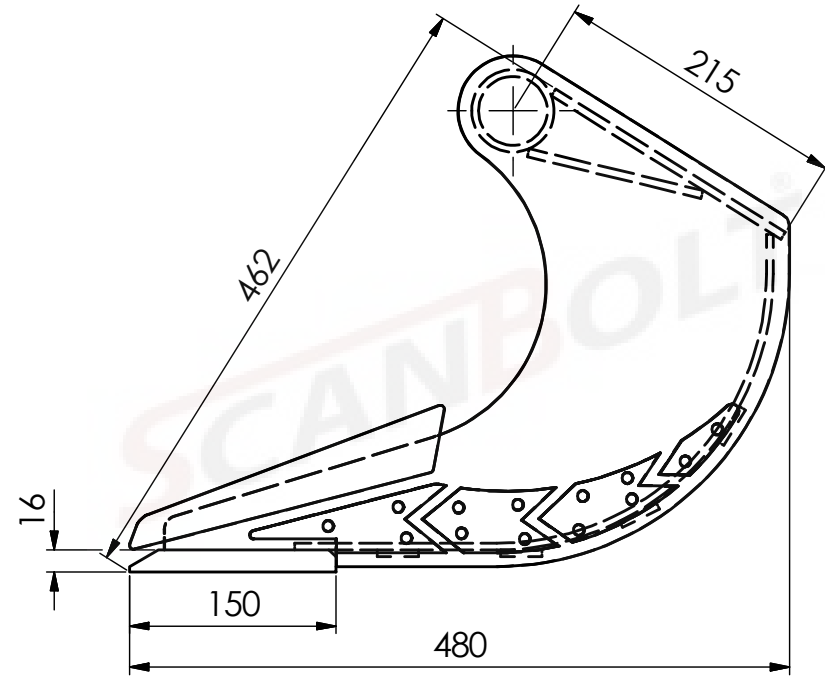
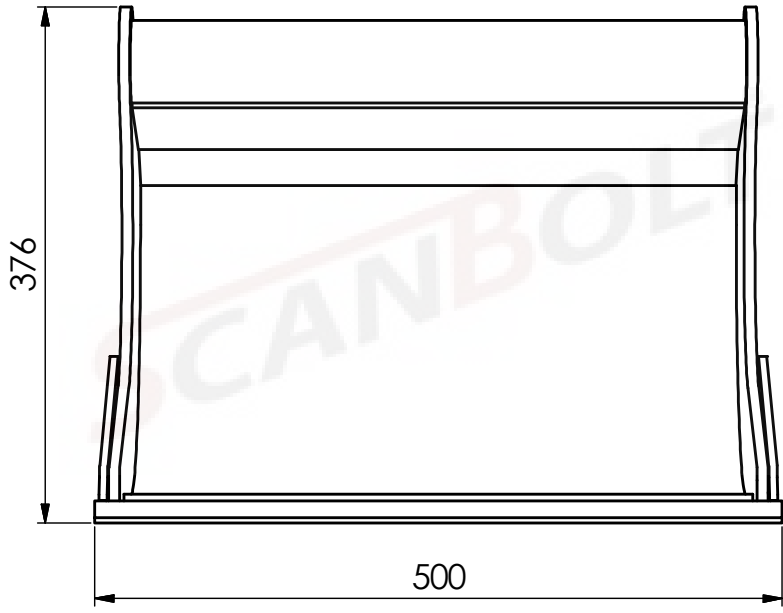
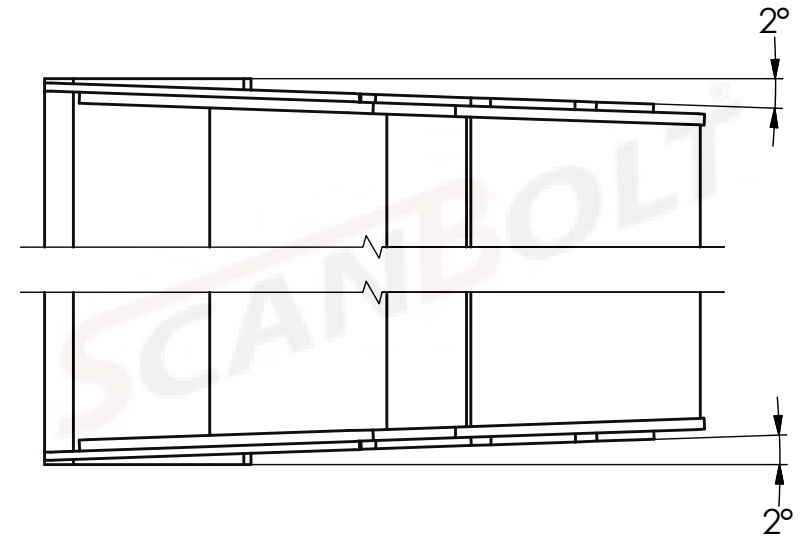
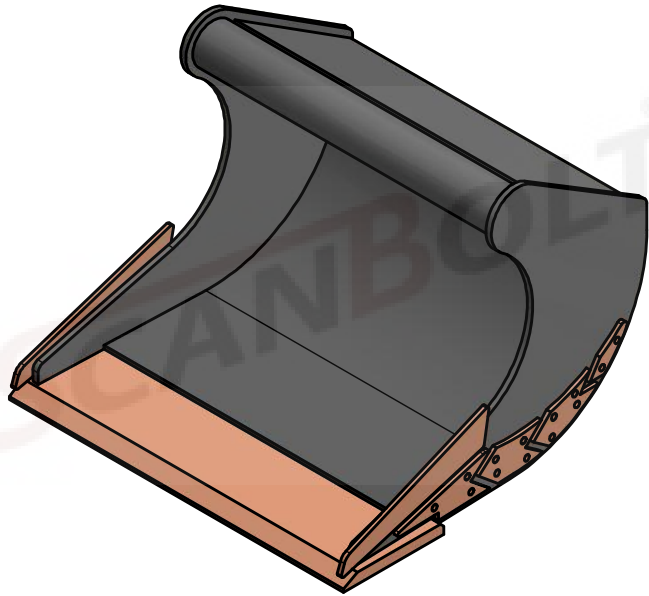
A

A



| MATERIAL SPECIFICATION   |                 |
|--|-----------------|
|  | ST52.3          |
|  | EN8D            |
|  | HB 400          |
|  | HB 450          |
|  | CASTALLOY STEEL |

| <b>SCANBOLT®</b> |                  |
|------------------|------------------|
| DESCRIPTION      | 50CM CLAY BUCKET |
| MACHINE CLASS    | 1.3-2.4 TON      |
| WEIGHT           | 41.3 Kg          |
| HEAPED CAPACITY  | 53.7 LITERS      |

8 7 6 5 4 3 2 1